



School & College Range  
Airone 1000DS  
Semi-Mobile Ducted Fume Cupboard

[www.safelab.co.uk](http://www.safelab.co.uk)



# Airone 1000DS

2

## School & College Semi-Mobile Ducted Fume Cupboard

The **Airone 1000DS** Semi-Mobile Ducted Fume Cupboard has been designed to comply with BS EN14175 for Ducted Fume Cupboards and G9 Fume Cupboards in schools, and has been tested by CLEAPSS.

The intelligent design of this cupboard creates a fully ducted system which is semi-mobile.

The Airone 1000DS' design has two major advantages:

- 1) The teacher and pupils are protected from the effects of the substances being used, as harmful fumes/irritants are removed at source and ducted away from the classroom environment entirely to atmosphere.
- 2) Easily stored to the side of the room, the cupboard can be wheeled into an open position within two metres for demonstrations. With 360° visibility, everybody can see what is happening at all times.



▲ Airone 1000DS

## Airone 1000DS

### Classroom Unit

#### Standard Specification

- Remote gas service
- Remote water service including drip cup and bottle trap
- Electrical socket

#### Construction

- Epoxy coated mild steel construction (RAL 7035)
- Clear back baffle and top panel
- Polypropylene spillage tray
- Stainless steel cill

#### Benefits & Features

- Air bypass system
- Sliding front sash
- Low airflow alarm
- Large front aperture
- Integral storage cupboard
- Restraining stainless steel tether
- No replacement carbon filter costs



# Safelab Docking Station

For Airone 1000DS & 1000RS fume cupboards/cabinets

## Airone Docking Station

For mobile and semi-mobile fume cupboards

The **Safelab Docking Station** provides secure connection of services (usually gas, electricity, water and waste) to our mobile and semi-mobile fume cupboards/cabinets.

The mobile ductless (recirculating) Airone 1000RS or semi-mobile ducted Airone 1000DS is simply moved into place for the demonstration, the castors are locked, and the services connected. The stainless steel tether fitted to the fume cupboard/cabinet allows it to be positioned up to 1.6 metres away from the docking station (model dependent).

After the demonstration the services can be straightforwardly disconnected, the docking station securely locked, and the fume cupboard/cabinet conveniently moved out of the way.

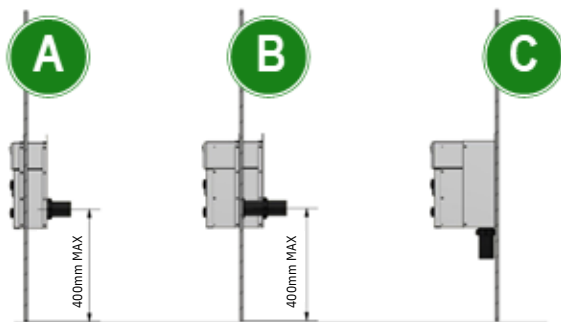

### Mounting Options:

Can be mounted in three different ways. Options A and B using the standard docking station kit.

C requires the optional docking station spacer (part number: 020225).



▲ Docking station to left of 1000RS



▲ Docking station to left of 1000RS

# Technical Information

## Mechanical Data

### Airone DS Semi-Mobile Ducted Fume Cupboard

<b>Min. Working Height</b>	200mm[1]
<b>Max. Working Height</b>	365mm[1]
<b>Usable Internal Height</b>	865mm[2]
<b>Power Supply</b>	230V, 50Hz
<b>Main Construction</b>	Mild Steel
<b>Air Volume @ 0.5m/s</b>	550m <sup>3</sup> /hr

[1] From worktop to sash.

[2] From worktop to lowest point of top baffle.

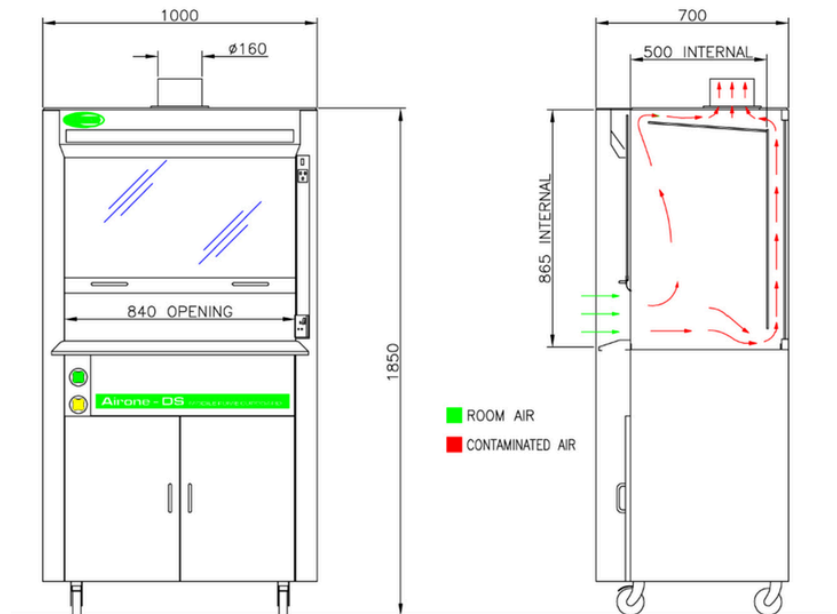

## Docking Station Guide

1. 13A switched socket outlet
2. 1/8" BSP natural gas coupling plug
3. 1/4" BSP water coupling plug
4. 1 1/2" BSP waste pipe coupler
5. Fume Cupboard tether attachment

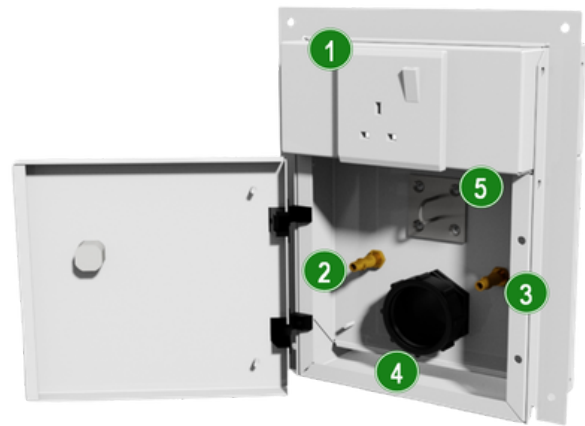

## 5-Year Warranty

A 5-year manufacturer's warranty is supplied as standard\* with Airone DS school fume cupboards. COSHH Regulation 9 stipulates that this type of equipment should be tested and calibrated at intervals of no greater than 14 months to ensure continued safe operation.

To ensure compliance with this mandatory requirement, Safelab can provide full testing and routine servicing of fume cupboards, which is the key to sustained safety, reliability, and economy.

\*Subject to Safelab carrying out annual testing.

# Service & Maintenance

Precision Maintenance for Peak Lab Performance

5

It is a **legal requirement** that all fume cupboards/cabinets undergo a **thorough examination and test at least every 14 months** to comply with COSHH Regulation 9. Safelab provides nationwide service and maintenance for **all makes and models** of fume cupboards and laminar flow cabinets whether ducted or filtered.

## Trusted Expertise

Our service engineers are highly trained and accredited, including **COSHH LEV P601 qualification**, ensuring compliance with legislation and peace of mind for our clients. All staff are **DBS-checked** and operate to strict safety standards. We test and maintain to the latest regulations and guidance:

- **BS EN 17242**
- **BS EN 14175**
- **COSHH REG9**
- **HSG258**
- **CLEAPSS G9 (schools)**



Safelab is also accredited by **Reset**, **Constructionline**, **SafeContractor**, **CHAS**, and **Building with Confidence**, reflecting our strong health and safety culture.

## What Our Thorough Examination & Test Includes

- Operation checks on the fume cupboard/cabinet and services
- **Qualitative (smoke)** and **quantitative (anemometer)** airflow assessments
- Condition and operation checks on **external fans and ductwork** (where applicable)

## Flexible Service Programs

We offer a choice of service plans to fit your requirements:

- **Routine inspections** and maintenance visits
- **Specialist testing** for clients needing additional performance certification

Safelab keeps your laboratory safe, compliant, and running smoothly with tailored support you can rely on.



With over 40 years of experience, Safelab, now part of the SDI Group, is a leading UK designer and manufacturer of high-quality fume cupboards and safety cabinets. Since 2003, we have produced more than 11,000 fume cupboards and provide servicing and support to more than 2,500 customers each year.

We work with a broad spectrum of clients, from pharmaceutical organisations, industrial R&D facilities, and major universities to schools and small laboratories.

By collaborating closely with consultants (often with BIM and REVIT information), laboratory furniture specialists, leading construction firms, and end users, Safelab has become the preferred supplier for many of the UK's largest laboratory projects.

### What Safelab stands for:

- Exceptional manufacturing quality
- Expert consultation
- Outstanding customer support
- Continuous innovation

To meet the diverse needs of our clients, we offer both filtered and ducted fume cupboards, delivering tailored solutions for every environment.

We also test, maintain, and service fume cupboards from any manufacturer, ensuring full compliance with COSHH Regulation 9.

### Commitment to Excellence

Our dedication to quality, innovation, and customer care ensures that every Safelab fume cupboard is built to the highest standards.

With Safelab, you can be confident you are choosing the very best in laboratory safety and fume extraction technology.



# Safelab School & College Products

Integrated Products. Consistent Protection.

7

AIRONE X2 DUCTED  
FUME CUPBOARD



AIRONE R3  
FILTRATION FUME  
CABINET



AIRONE 1000RS  
MOBILE FILTRATION  
FUME CABINET



AIRONE 1000DS  
SEMI-MOBILE DUCTED  
FUME CUPBOARD



DOCKING STATION  
FOR AIRONE 1000RS  
& 1000DS



POLYPROPYLENE  
STORAGE CABINET



## Extract Duct

The Airone X2 and Airone 1000DS ducted fume cupboard ranges must be connected to an extract system with a properly sized fan to manage pressure loss and effectively remove harmful fumes.

Safelab Systems has extensive experience supplying and installing these systems, whether for new builds or retrofitting into existing structures. By collaborating with architect, contractor, and end users, we ensure smooth installations.

## Typical Duct Routes

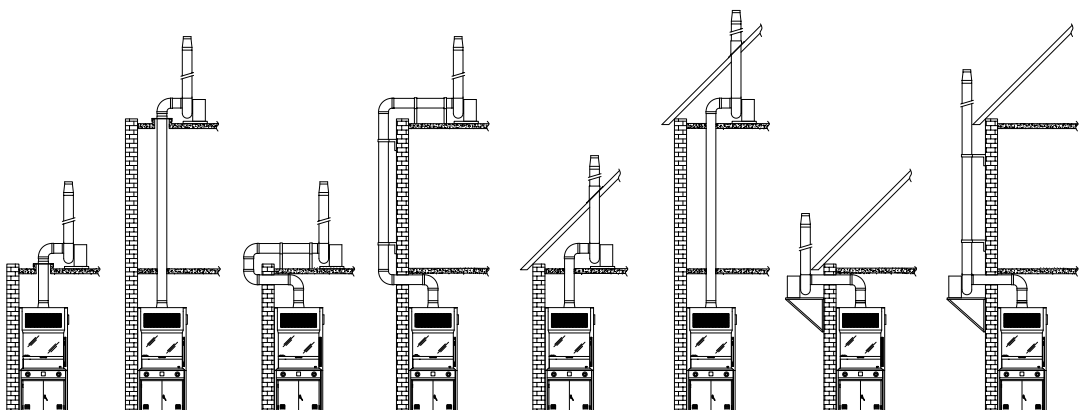



UK Headquarters  
Airone Building  
8 Beaufighter Road  
Weston Super Mare  
Somerset  
BS24 8EE

[www.safelab.co.uk](http://www.safelab.co.uk)  
[safelab@safelab.co.uk](mailto:safelab@safelab.co.uk)  
+ 44 (0)1934 421340

